

TASK: Slats will not tilt – ½” and 1” Horizontal Aluminum

Use If/When: Slats will not tilt

Tools Needed: Flathead screwdriver

1. If possible, tilt the slats horizontally. Lift and lock the slats in the raised position. Remove the blind from the mounting brackets by pushing the tab on the bracket away from the blind.



2. Slide the tilt rod completely into the tilter mechanism. The tilt rod will be inserted so you can see it on both sides of the tilter mechanism.



3. Make sure the mounting hardware is not interfering with the tilt components. If necessary, reposition brackets or valance clips if applicable so no components are obstructed.

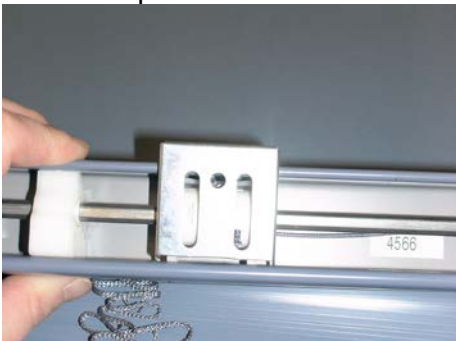

4. Be sure the tape drum is completely pressed down onto the tilt rod.

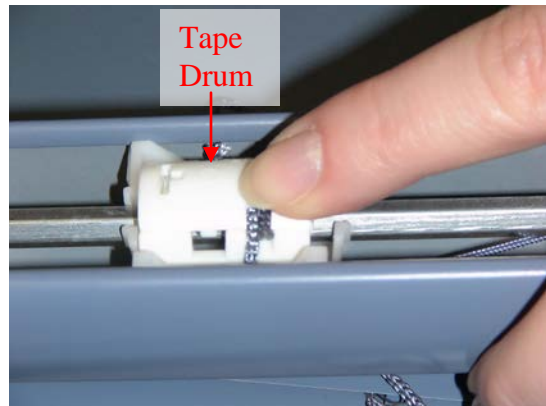

TASK: Slats will not tilt – ½” and 1” Horizontal Aluminum

Use If/When: Slats will not tilt

Tools Needed: Flathead screwdriver

5. The tab on the tilter should be on the top.

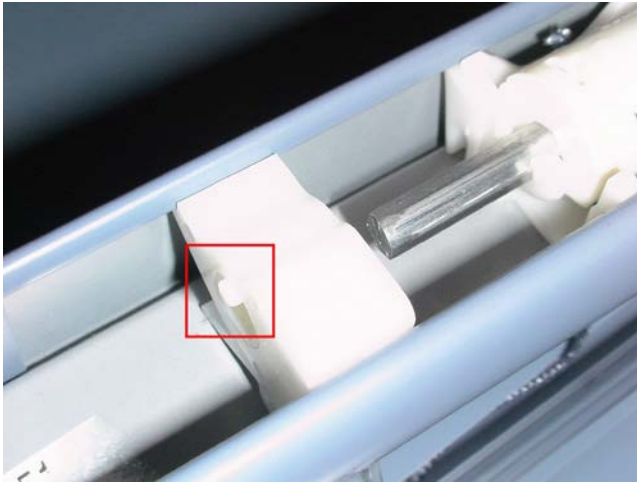

6. If the tab is not to the top, remove end cap at opposite end of tilter. Slide the tilt rod out of tilter mechanism. Reposition the tilt mechanism. **Note:** Turn the tilter stem and the tab at the same time to reposition the tab to the top.



7. Keeping the blind level, reinsert the tilt rod.



8. Tilt the slats to make sure the blind operates properly.



TASK: Slats will not tilt – ½” and 1” Horizontal Aluminum

Use If/When: Slats will not tilt

Tools Needed: Flathead screwdriver

9. Reinstall blind in brackets. Reinstall valance in clips if applicable.

