

TASK: Replace Cord Loop for Simpull/Continuous Loop Wood Blinds

Use If/When: Cord Loop needs replaced on a Simpull/Continuous Loop wood blind due to breakage or a different loop size is requested.

Tools Needed: Flathead screwdriver

1. Raise blind completely. Remove screw to release tensioner at the bottom of the continuous cord loop.



2. Remove valance by sliding it downwards from the valance clips and set aside.



3. Remove blind from installation brackets using a flat head screwdriver. Place screwdriver under the front lip of all brackets and rotate headrail forward to release.



4. Set the blind on a flat surface and remove clutch endcap by placing a screwdriver under the lip at the top of the clutch and twist.



TASK: Replace Cord Loop for Simpull/Continuous Loop Wood Blinds

Use If/When: Cord Loop needs replaced on a Simpull/Continuous Loop wood blind due to breakage or a different loop size is requested.

Tools Needed: Flathead screwdriver

5. While holding onto the entrance cord (top portion of cord loop) manually rotate clutch counterclockwise until the cord is free from the around the gear.

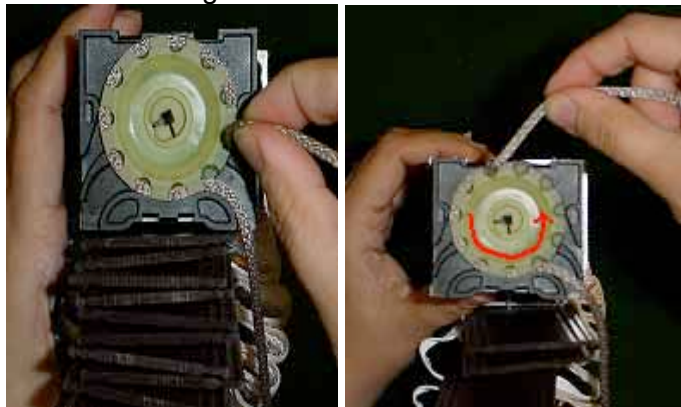

6. Reinstall the new continuous cord loop by gently turning and wrapping the loop under the teeth of the clutch.

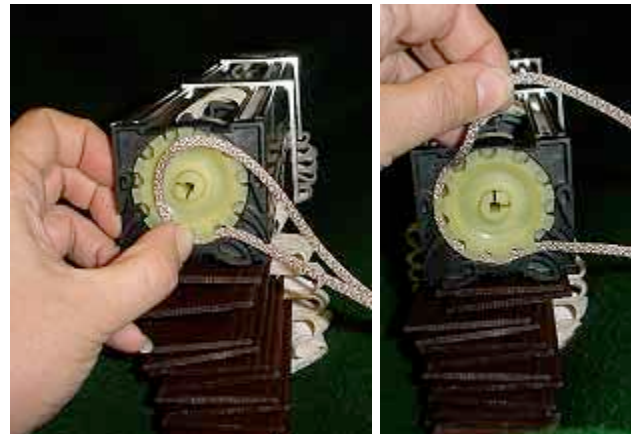

7. Reattach the clutch end cap by first fastening the end cap to the bottom of the clutch and then snapping the top clip.



8. Reinstall blind into brackets by slipping the lower lip of the headrail into the mounting bracket. Rotate the front of the rail so that the bracket snaps and catches the front upper lip of the headrail.



TASK: Replace Cord Loop for Simpull/Continuous Loop Wood Blinds

Use If/When: Cord Loop needs replaced on a Simpull/Continuous Loop wood blind due to breakage or a different loop size is requested.

Tools Needed: Flathead screwdriver

9. Pull down and hold to mount tensioner using screw for inside mount or bracket and screw for outside mount.



10. Reinstall valance by sliding it upwards onto the valance clips.

